

17/8171 Bramble House and Bracken Cottage Alston Development Plan

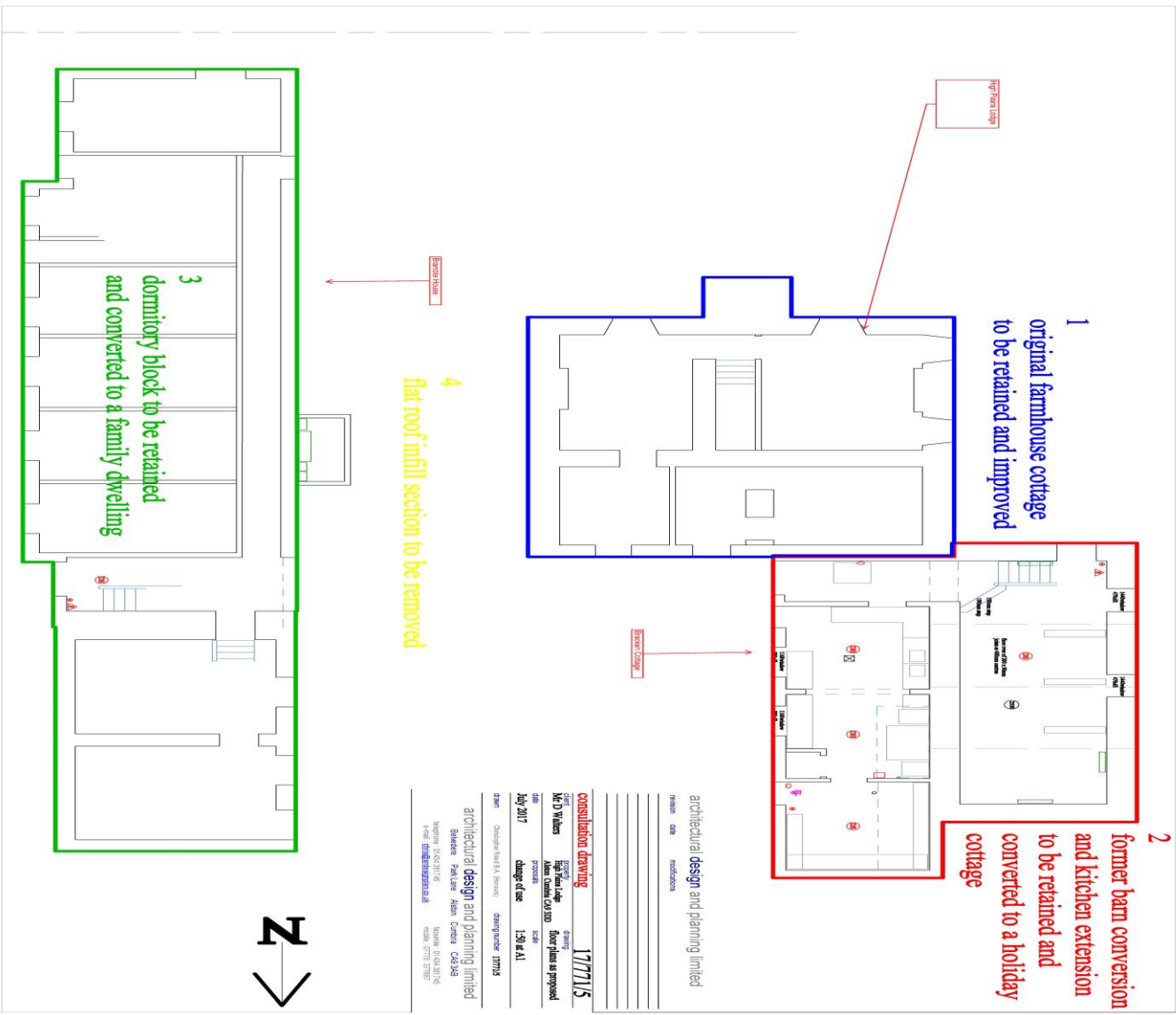



1
original farmhouse cottage
to be retained and improved

2
former barn conversion
and kitchen extension
to be retained and
converted to a holiday
cottage

3
dormitory block to be retained
and converted to a family dwelling

4
flat roof infill section to be removed

architectural design and planning limited
reason: site
provisions

consultation drawing 17/7/15

client: Mr D Wilkins
project: High Street Ridge
address: Alden Green CV35D
date: 15/07/15
drawing no: 1.5/1 & 1/1

drawn: Catherine Field & Jonny
drawing under: rmm/s
architectural design and planning limited
Bunadey Park Lane Alden Green CV35D
Wotton 10/10 10/10
t: 0121 7071000
e: info@adpdesignplanning.co.uk
r: 0121 7071000

