

15/8172 Sandsend House, Alston, Development Plan

Department of Corporate & Legal Services



Title: 15/8172 Sandsend House, Alston, CA9 3NF



© Crown Copyright and database rights (100023754)(2015).



Drawn by:
Section:

Scale: 1:2500
Date: 30th November 2015
Parish: Eden District Council
Grid Ref: 372819 ,548944

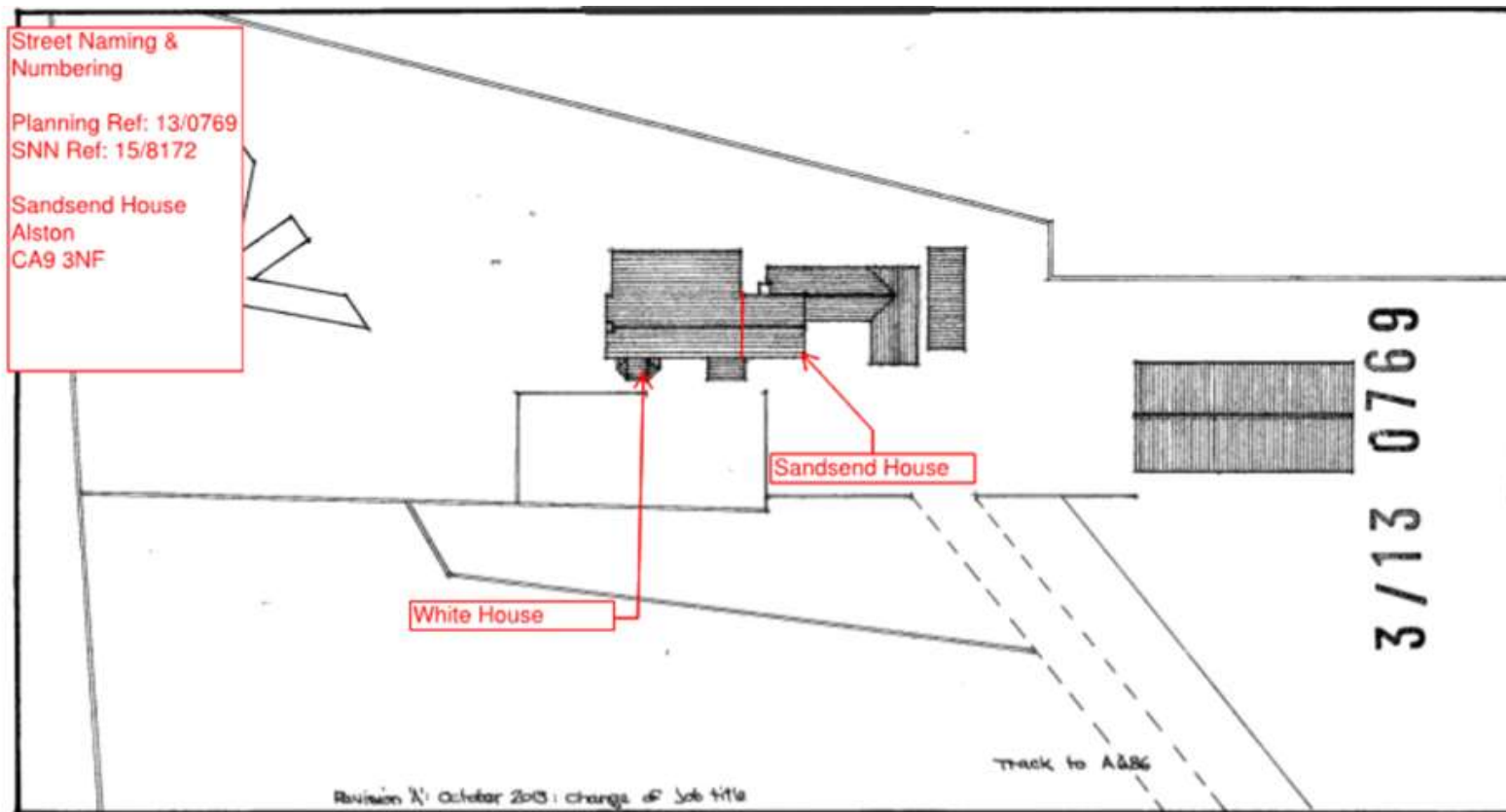

WHITE HOUSE, ALSTON
 PROPOSED DIVISION TO PROVIDE "ANCILLARY" ACCOMMODATION
 SITE PLAN AS EXISTING
 ReC. 50713 Dwg. SPEA August 2013 Scale: 1/500 Drawn by: A.F. ROBERTSON

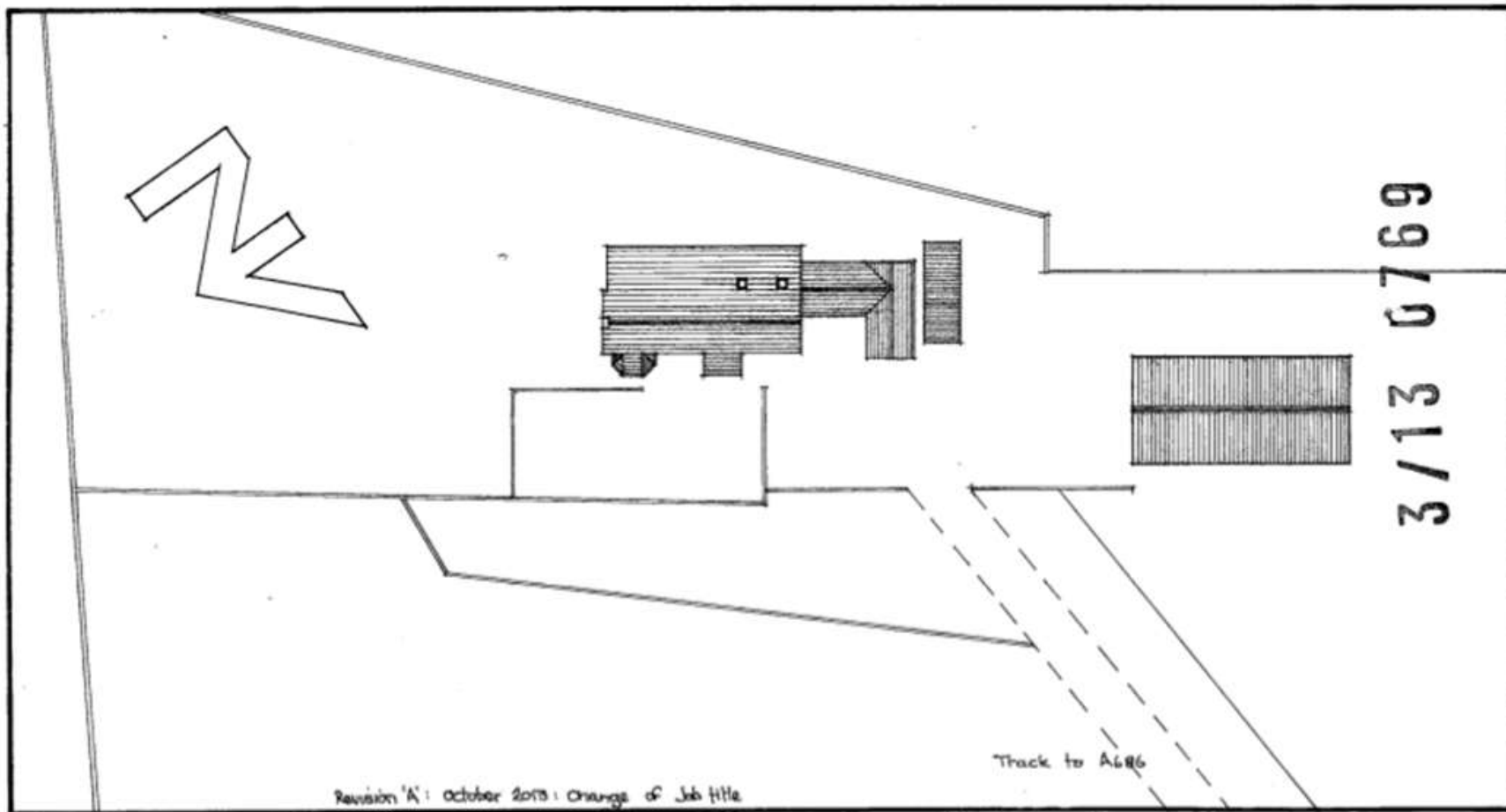

WHITE HOUSE , ALSTON
 PROPOSED DIVISION TO PROVIDE ANCILLARY ACCOMMODATION
 SITE PLAN AS PROPOSED
 Ref. 50713 Dwg. SPPA August 2013 Scale: 1/500 Drawn by: A.F. ROBERTSON