

14/8113 – Bingsteads House and Pennine Shed, Nenthead



BINGSTEADS YARD, Nenthead
 Alston, Cumbria, CA9 3LS
 For: Mr D. Palsley
 Job no: 13 22 Dwg no: L01 Rev 1
 LOCATION PLAN
 Scale: 1:1250 Date: 11/10/2013

STREET NAMING AND NUMBERING
PLANNING REF: 14/0304
SNN REF: 14/8113
GRID REF: 377751.544032

Bingsteads House
 Nenthead
 Alston
 CA9 3LS

Pennine Shed
 Bingsteads House
 Nenthead
 Alston
 CA9 3LS

APPROVED

RECEIVED
 16 DEC 2013

Produced 09/02/2013 from the Ordnance Survey National Geographic Database and incorporating surveyed revision available at this date. © Crown Copyright 2013

Reproduction in whole or in part is prohibited without the prior permission of Ordnance Survey.

Ordnance Survey and the OS Symbol are registered trademarks of Ordnance Survey, the national mapping agency of Great Britain.

The representation of a road, track or path is no evidence of a right of way.

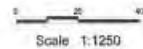

Supplied By: lakeland
 Serial number: 001119164

3/13 0949

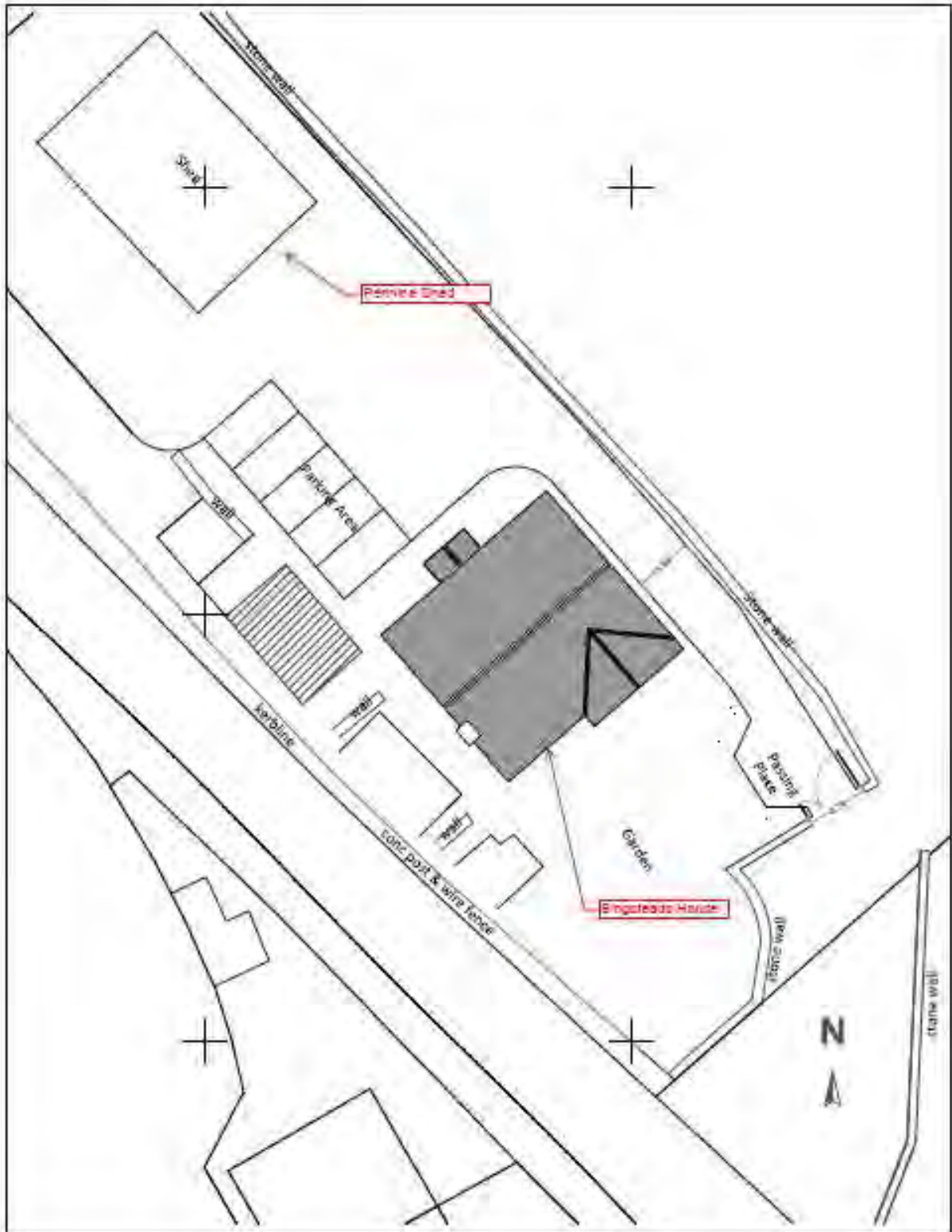

Countryside Consultants
Architects & Planners
200005, Market, Cumbria, CA1 1JF, Tel: 01422 58992
 www.countrysideconsultants.co.uk

Ringside Yard, Alston Road, Nenthead, Cumbria
 Proposed 4 Bedroom House
 Site Plan As Proposed
 1322 P1Rev A 05-09-2014 Scale 1:200 at A2