

# 15/8076 – 1-3 Joseph Gardens, Nenthead, Alston

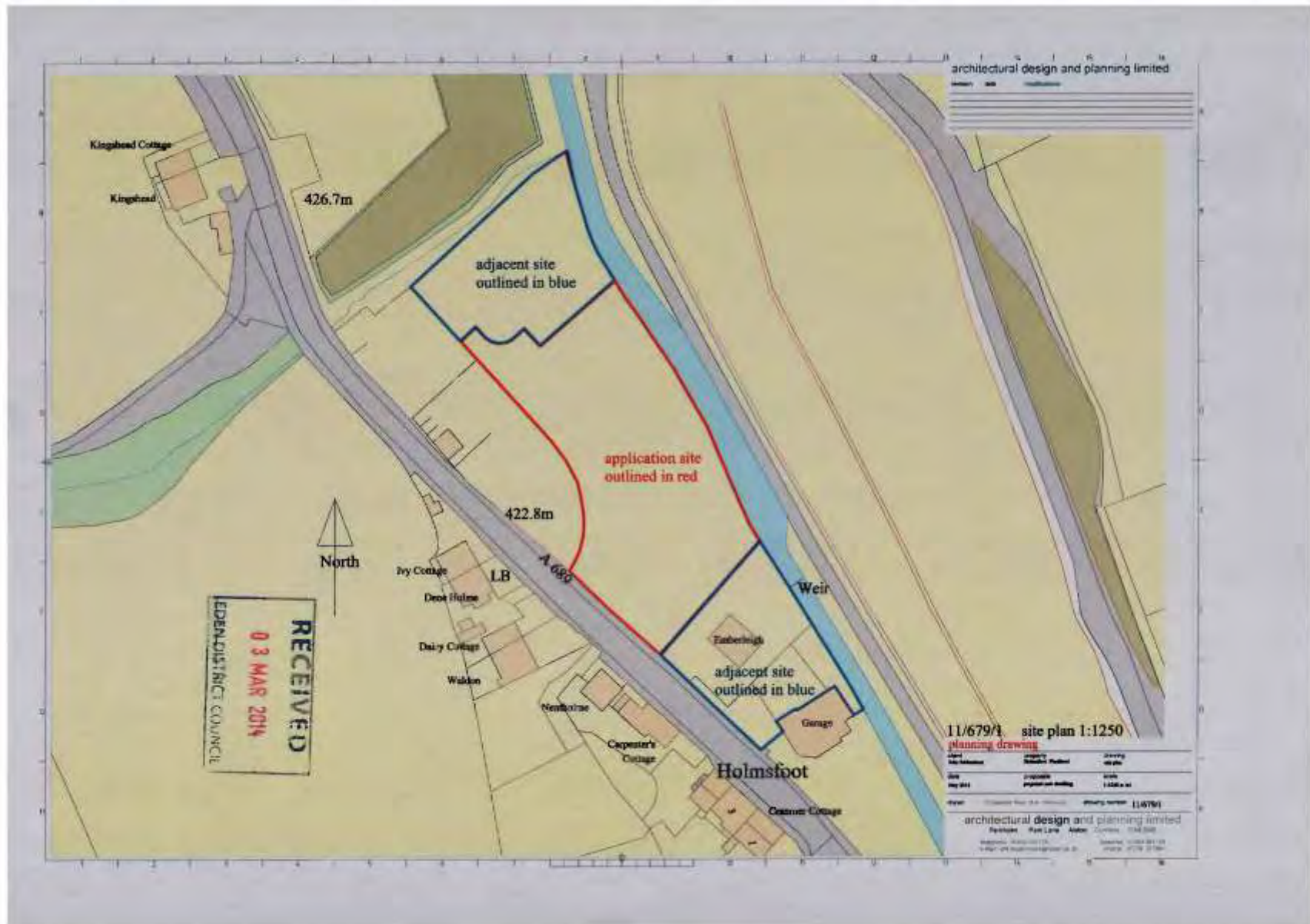

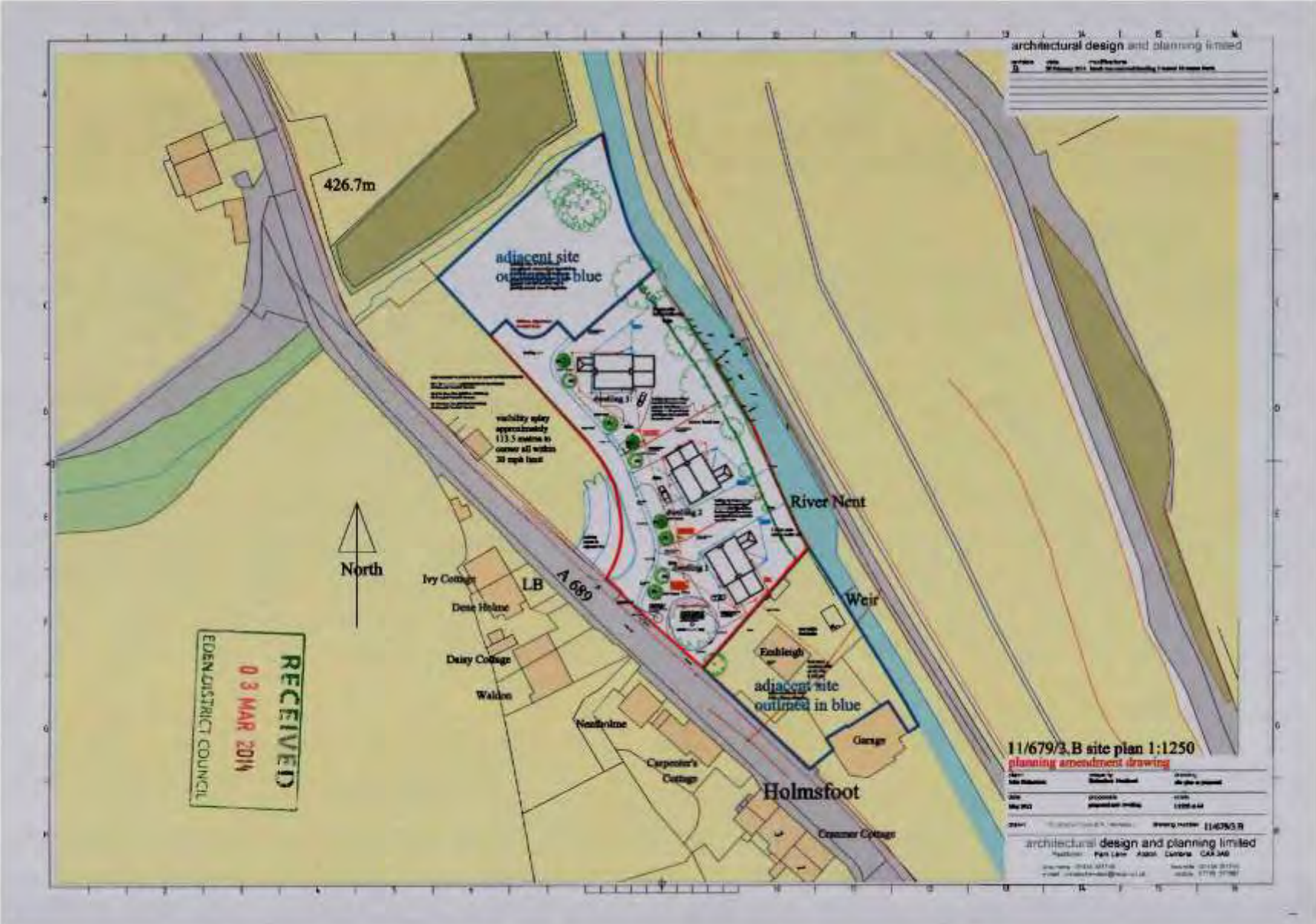

RECEIVED  
03 MAR 2011  
EDEN DISTRICT COUNCIL

architectural design and planning limited  
 address: 11/679/3.B  
 location: Eden District Council

11/679/3.B site plan 1:1250  
 planning amendments drawing  
 architect: architectural design and planning limited  
 address: Part Lane, Ashton, Carlisle, Cumbria, CA4 3AG  
 telephone: 01273 327740  
 email: info@architectural-design-and-planning.co.uk



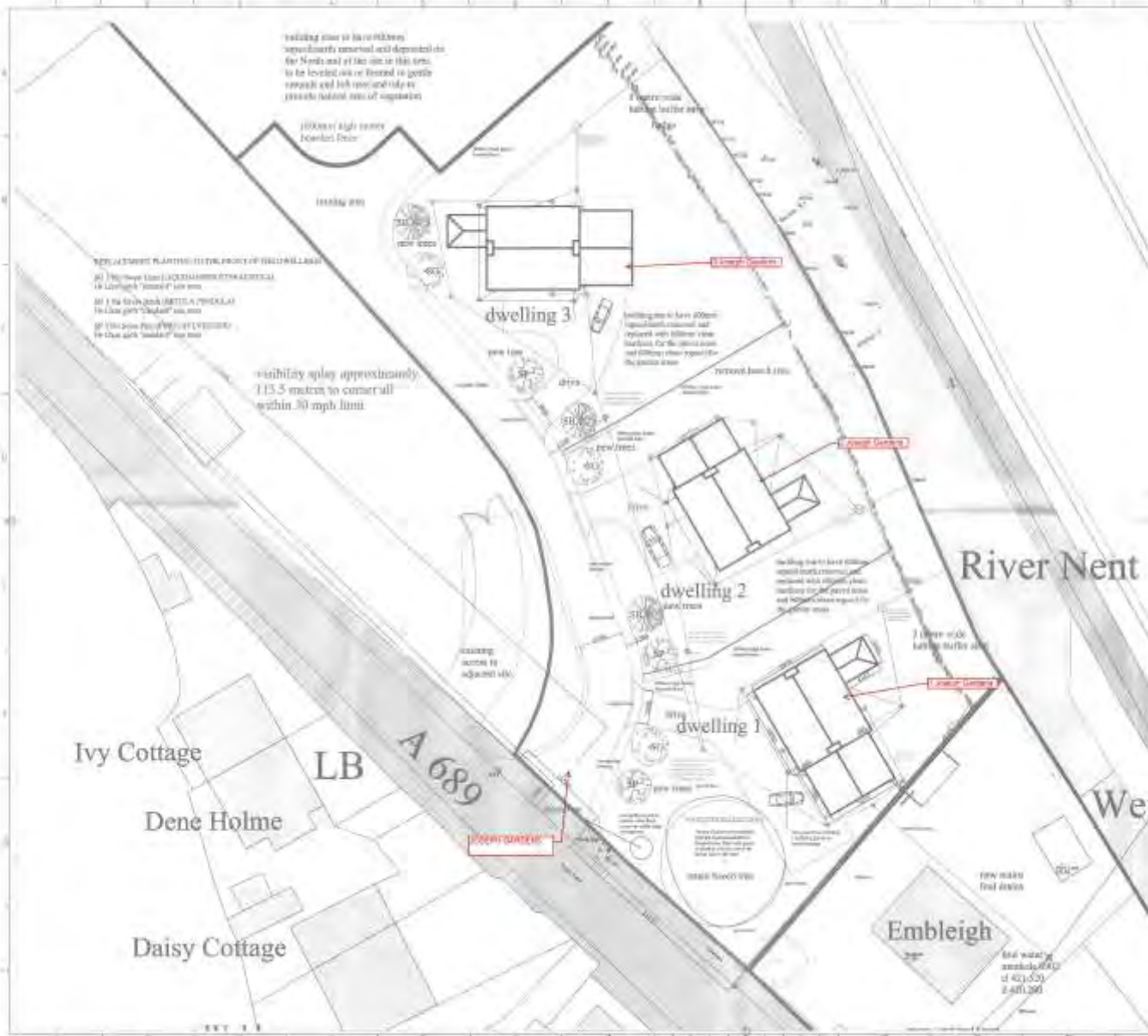

architectural design and planning limited

11	11/6795.D	block plan
12	11/6795.D	block plan
13	11/6795.D	block plan

**APPROVED**

Chief Planning and Planning  
 New South Wales  
 Planning Act 2016  
 Planning No. 14/0178  
 2000 No. 14/0178  
 Date Recd: 07/10/2016, 04/03/2017

11/6795.D  
 Joseph Hume  
 Planner  
 Date: 04/03/17

RECEIVED  
 3/14/0178

11/6795.D block plan 1:200  
 planning amendment drawing

client	John Richardson	project	Holcroft Northend block plan as proposed	drawing	
date	November 2012	project no	11/6795.D	scale	1:200 as AI

architectural design and planning limited  
 Parklands, New Lamb, Jalan Curdrie, Gungahlin, ACT 2911  
 Sydney, NSW 1500  
 Tel: 02 6207 1111  
 Fax: 02 6207 1111  
 Email: info@adpl.com.au  
 Website: www.adpl.com.au