

# 18/8052 Shepherds Garth

Full Planning Permission and Demolition in a Conservation area - Land at Croft House, Great Asby

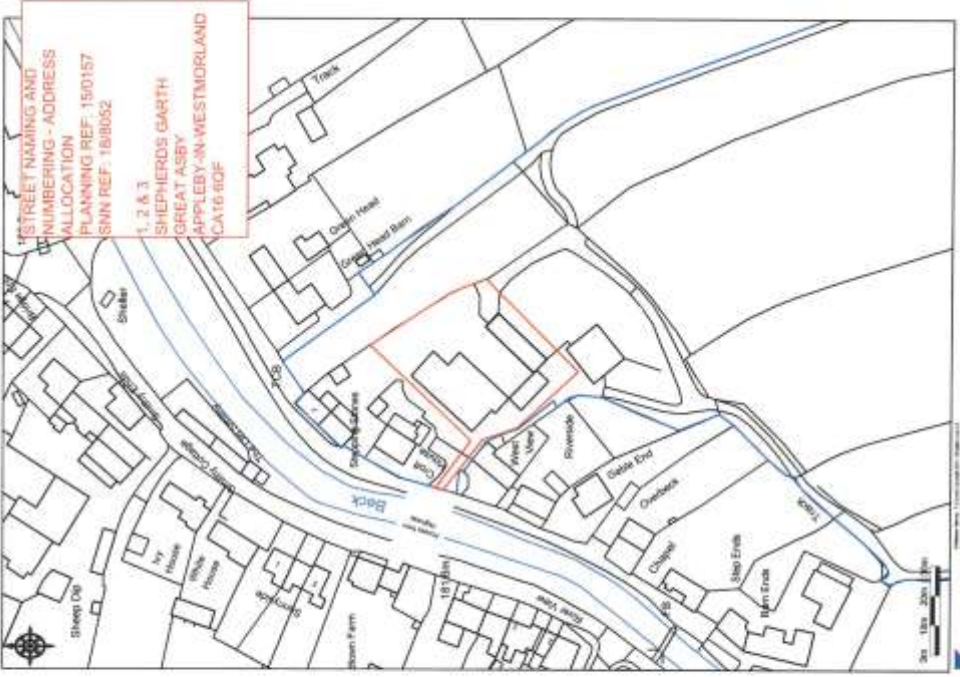

18/8052  
STREET NAMING AND  
NUMBERING - ADDRESS  
ALLOCATION  
PLANNING REF: 150157  
SNN REF: 180052  
1, 2 & 3  
SHEPHERD'S GARTH  
GREAT ASBY  
APPLEBY-IN-WESTMORLAND  
CAT16.60F

1834 Land and Property Ltd  
Client: Mr. B Pawk



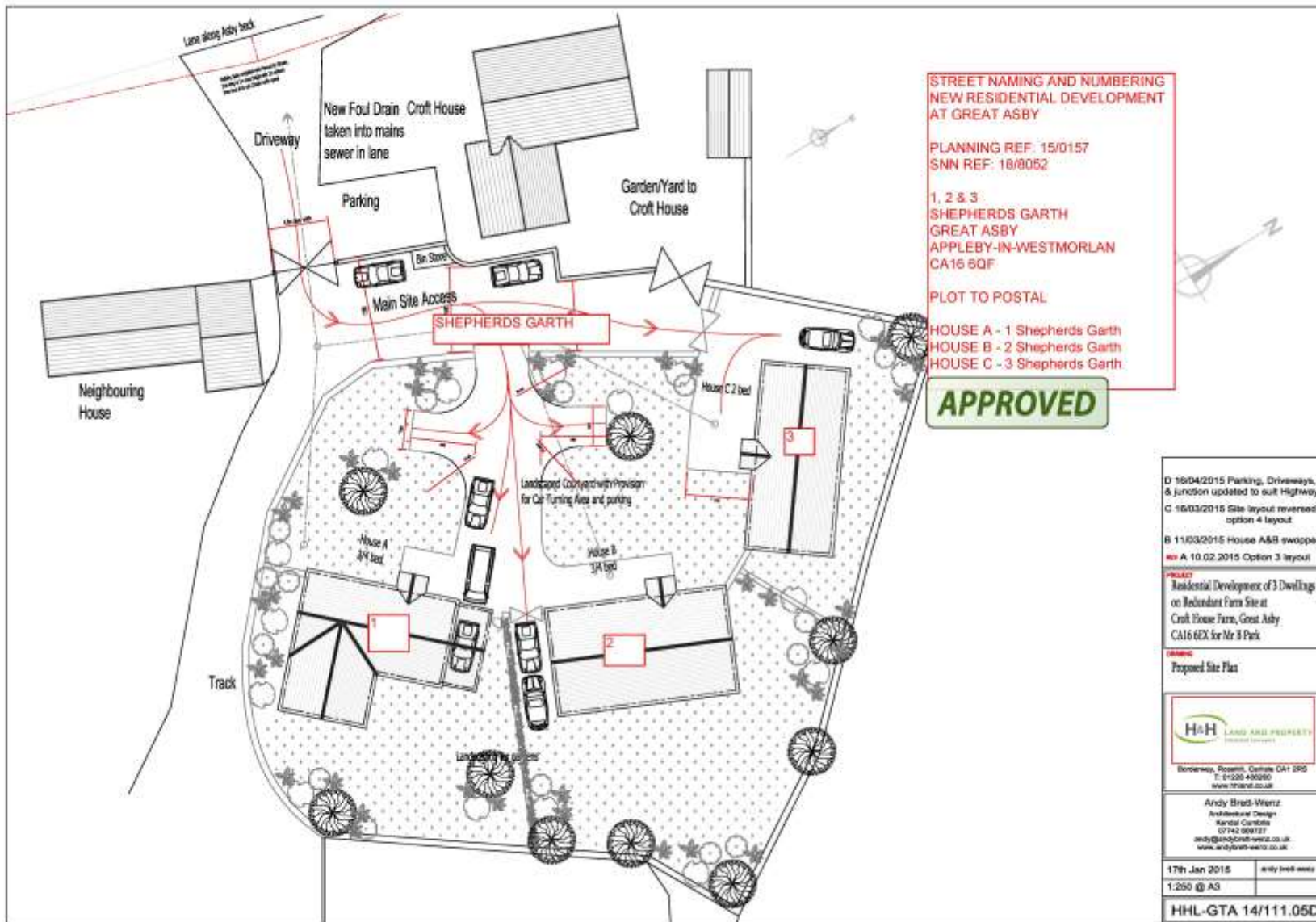

- D 16/04/2015 Parking, Driveways, & junction updated to suit Highways
  - C 16/03/2015 Site layout revised option 4 layout
  - B 11/03/2015 House A&B swapped
  - REV A 10.02.2015 Option 3 layout
- PROJECT**  
Residential Development of 3 Dwellings on Redundant Farm Site at Croft House Farm, Great Asby CA16 6EX for Mr B Park
- DRAWING**  
Proposed Site Plan

**H&H LAND AND PROPERTY**  
Landscape Architects

Barnesley, Rotherham, Central DA1 2RS  
T: 01226 498260  
www.handh.co.uk

Andy Brad-Wentz  
Architectural Design  
Rural/Country  
07942 089127  
andy@andybrad-wentz.co.uk  
www.andybrad-wentz.co.uk

17th Jan 2015     andy brad-wentz  
1:250 @ A3

HHL-GTA 14/111.05D