

18/8024 and 18/8042 1 and 2 Mounteden, Carleton

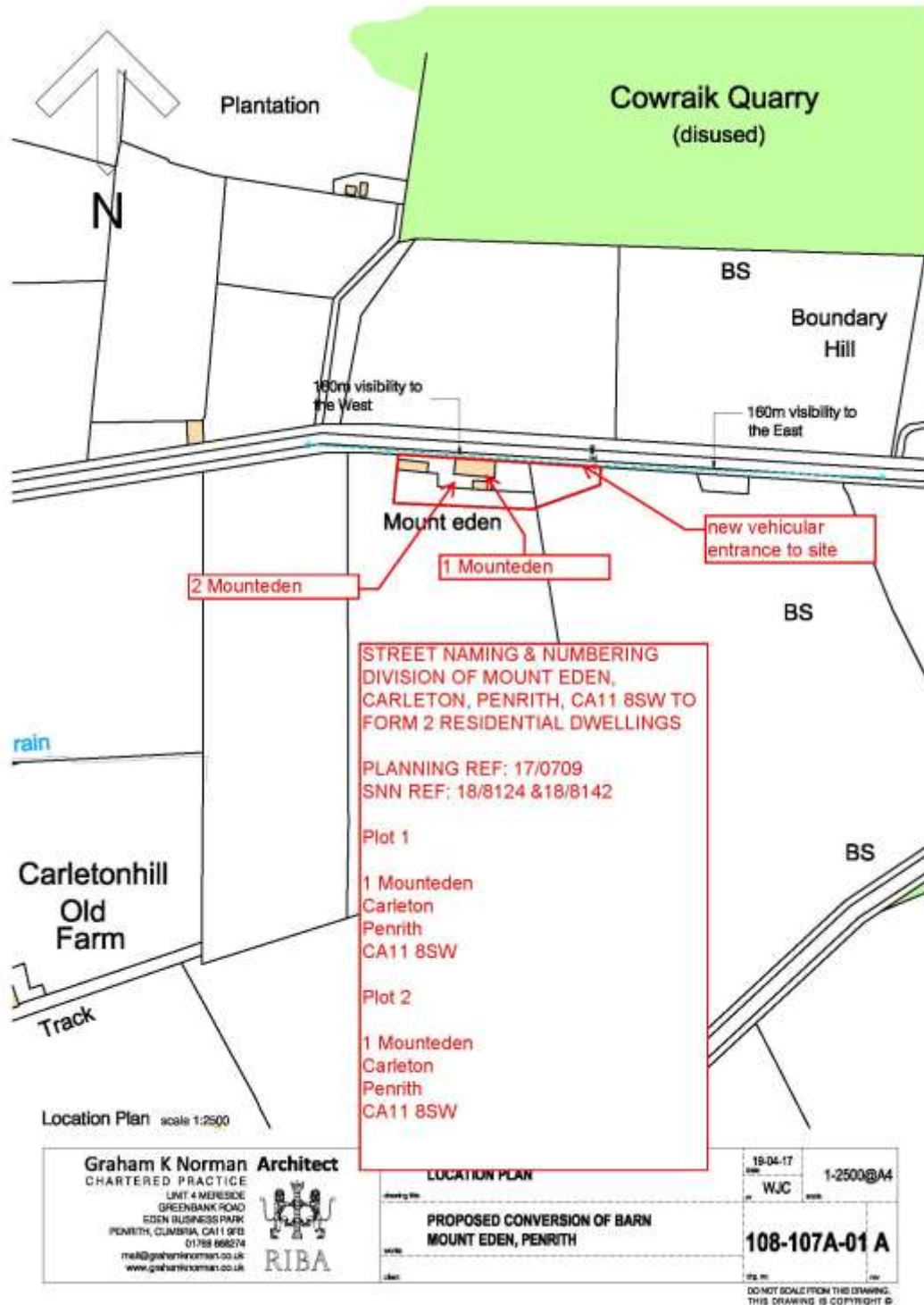

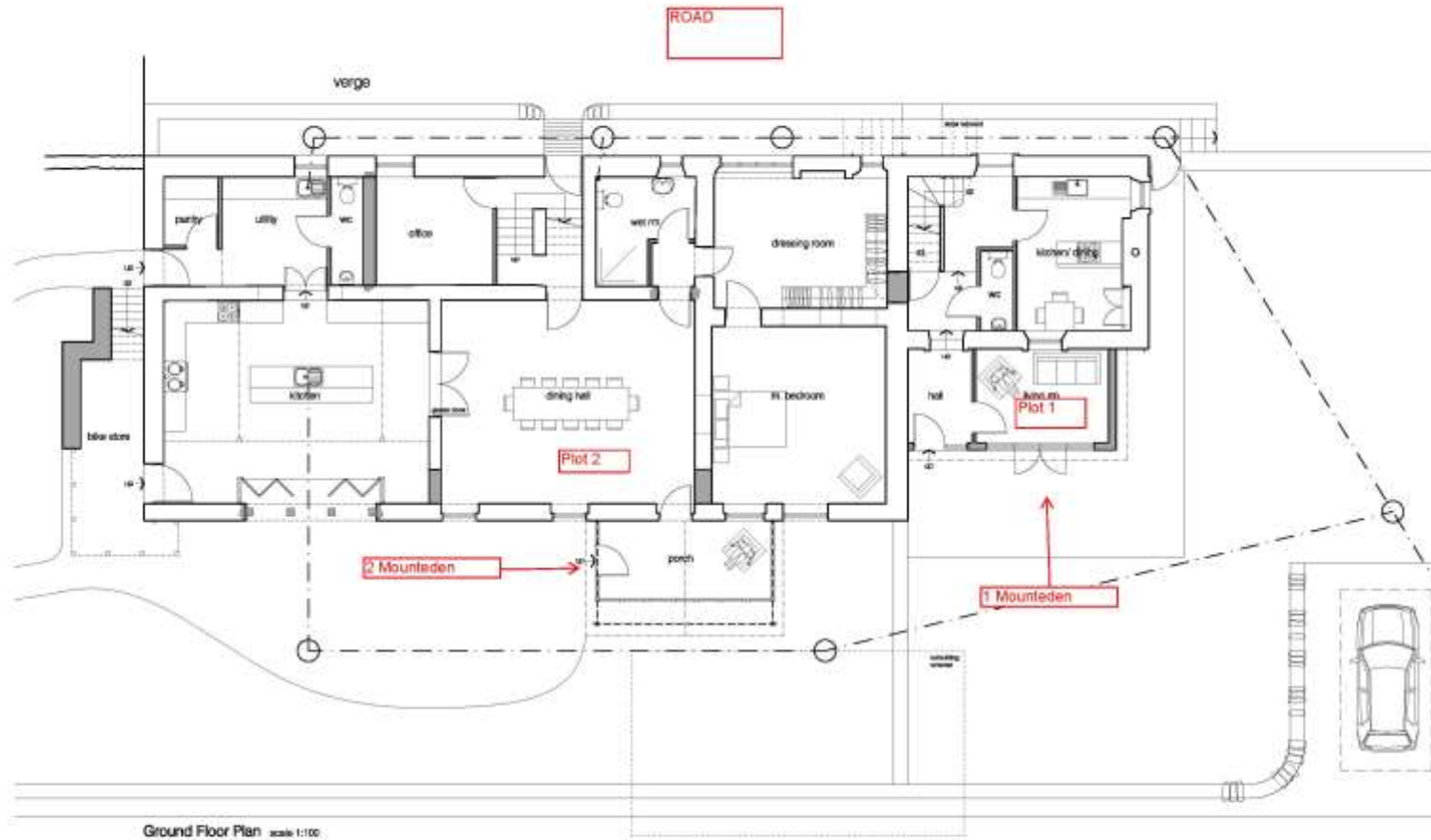

<small>DO NOT SCALE FROM THIS DRAWING THIS DRAWING IS COPYRIGHT ©</small>	<b>W8888</b> A 17-10-17 Access amended WUC	<b>Graham K Norman Architect</b> CHARTERED PRACTICE 5474 WINDROSE GREENBANK ROAD EDON BUSINESS PARK FENWICK, QUINCY, DN11 8PL 01509 865274 info@grahamknorman.co.uk www.grahamknorman.co.uk	<b>AS PROPOSED GROUND FLOOR PLAN</b>	10-04-17 WUC	1-100@A3
	<b>PROPOSED CONVERSION OF BARN MOUNT EDEN, FARNITH</b>		<b>108-107A-07 A</b>		